



Cantwell Road, Shooters Hill, SE18 3LW

Price £0 Leasehold



GROUND FLOOR
546 sq.ft. (50.8 sq.m.) approx.

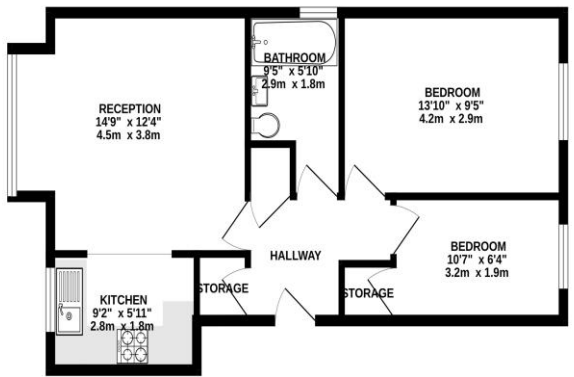

TOTAL FLOOR AREA: 546 sq.ft. (50.8 sq.m.) approx.
 All measurements are approximate and should not be relied upon for any legal or financial purposes. The actual area and dimensions may vary slightly from those shown on this plan. Measurements are taken to the face of walls and doors. Measurements are taken to the face of walls and doors. Measurements are taken to the face of walls and doors. Measurements are taken to the face of walls and doors.

To arrange an appointment to view this property or to book a valuation on your own property, contact hi residential for a professional Prompt and friendly service

experience the hi residential way

Property Details

Hi Residential is delighted to present this inviting two-bedroom ground floor flat, perfectly positioned in a serene residential area on the popular slopes of Shooters Hill. This property offers a peaceful living environment with the convenience of ground floor access, ideal for a variety of home seekers, including those looking to downsize, first-time buyers, or investors. As you enter the flat, a welcoming entrance hall leads you into a cozy lounge that serves as a perfect space for relaxation and socializing. The lounge flows into a well-equipped fitted kitchen, which provides all the necessary amenities for daily cooking and dining. The flat also features two well-proportioned bedrooms, each offering a comfortable and private space for rest and rejuvenation. A neatly appointed bathroom completes the internal layout, ensuring functional and comfortable living for all occupants. Externally, the flat benefits from expansive communal gardens, providing a lovely outdoor area for relaxation and leisure. These well-maintained green spaces add to the charm and appeal of the property, creating an ideal setting for outdoor enjoyment. Additionally, the property comes with an allocated parking space, adding a layer of convenience for residents with vehicles. This ground floor flat is an excellent choice for those seeking a tranquil yet connected lifestyle. Its location on the slopes of Shooters Hill allows for easy access to local amenities and transport links, while offering a quiet retreat away from the hustle and bustle of the city center. Early viewing is highly recommended to appreciate the layout, setting, and overall appeal of this delightful flat. Contact Hi Residential today to schedule your visit and explore the possibility of calling this charming property your new home.

