

Score	Energy rating	Current	Potential
92+	A		
81-91	B	81 B	81 B
69-80	C		
55-68	D		
39-54	E		
21-38	F		
1-20	G		

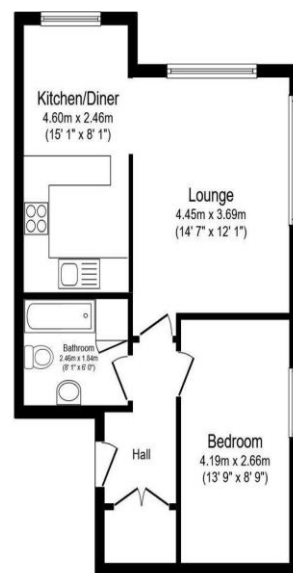

Total floor area 49.3 sq.m. (530 sq.ft.) approx.
 This floor plan is for illustrative purposes only. It is not drawn to scale. Any measurements, floor areas (including any total floor area), openings and orientation are approximate. No details are guaranteed, they cannot be relied upon for any purpose and they do not form part of any agreement. No liability is taken for any error, omission or misstatement. A party must rely upon its own inspection(s).
 Plan produced for You Move. Powered by www.localagent.com

To arrange an appointment to view this property or to book a valuation on your own property, contact hi residential for a professional Prompt and friendly service

24 Plumstead Common Road, SE18 3TN
 Tel: 020 8316 6616
 Email: sales@hi-residential.com
 Email: lettings@hi-residential.com
 www.hi-residential.com



Meadowford Close, Central Thamesmead, Price £190,000 Leasehold



MI 11 ULTRA | HI RESIDENTIAL

24 Plumstead Common Road, SE18 3TN
 Tel: 020 8316 6616
 Email: sales@hi-residential.com
 Email: lettings@hi-residential.com
 www.hi-residential.com



Property Details

Nestled within the vibrant community of Thamesmead, this purpose-built, first floor one-bedroom flat offers convenience and comfort, ideal for first-time buyers or investors. Positioned close to local amenities and well-connected bus routes, residents have easy access to the DLR, Elizabeth Line, and mainline stations, facilitating smooth commutes to various parts of London. The flat welcomes you with a neat entrance hall that leads into a generously sized lounge and kitchen area. This space is perfect for relaxing and entertaining, with ample room for both living and dining setups. The kitchen area is well-appointed, accommodating all essential appliances and storage needs. The bedroom is a comfortable double, providing a peaceful retreat with sufficient space for furnishings. Completing the layout is a well-maintained bathroom equipped with modern fixtures. Additional highlights of this property include a private parking space, adding significant value and convenience for vehicle owners. The flat's ground floor location allows for easy access, making it suitable for a variety of residents. Early viewing of this flat is highly recommended to appreciate its location, layout, and the lifestyle it offers. It's an excellent opportunity to secure a home in a sought-after area of Thamesmead, close to shopping, transport links, and local services. Don't miss out on this appealing property.

